

APPLICATIONS

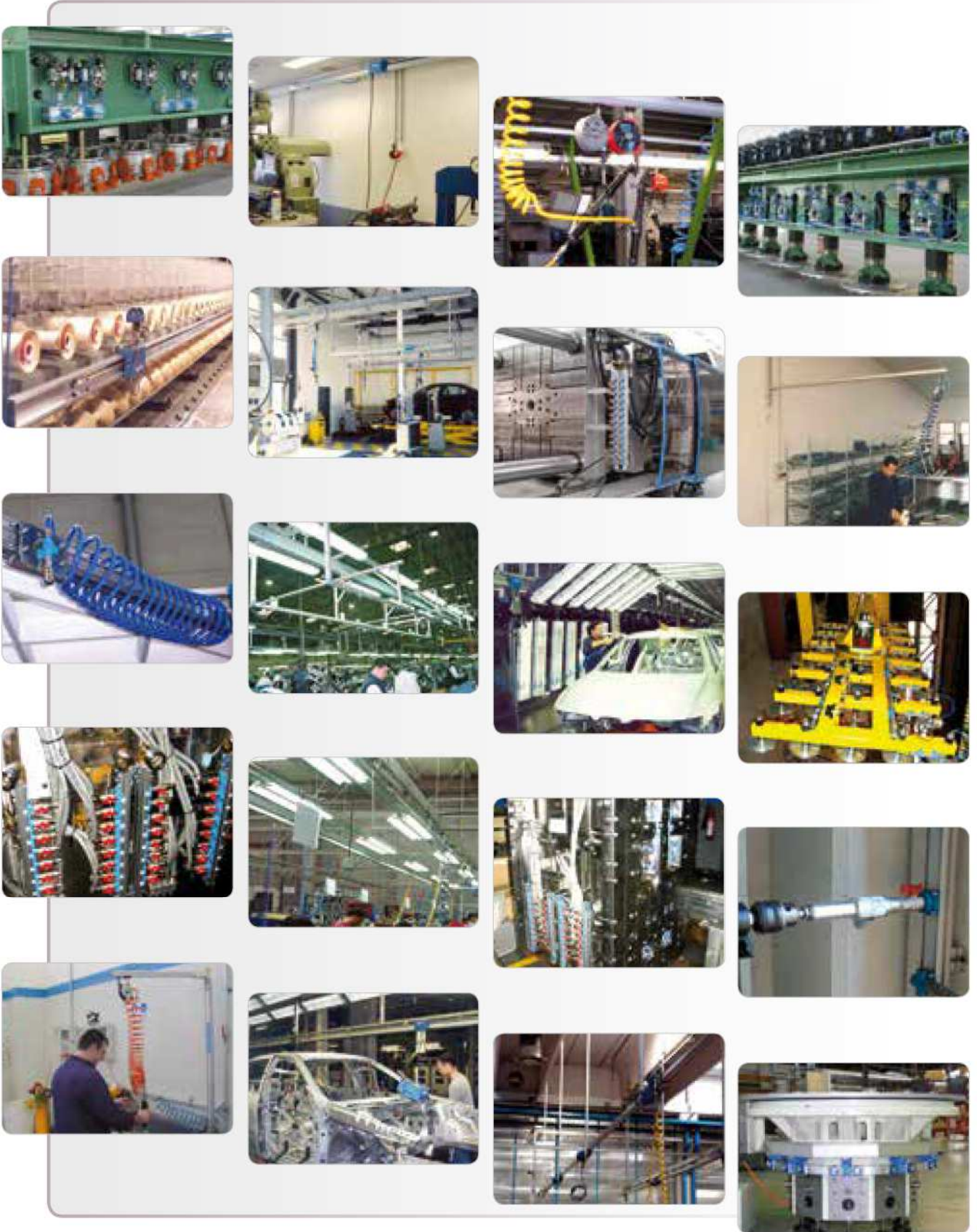



THREADED STRAIGHT PUSH FITTING

HBS

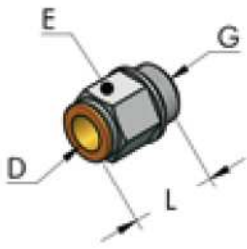
AP



D mm	G	L mm	E mm	Part. no.	P g	n°	
14	3/8" - BSP	36	22	413 017 036	46	20	
14	1/2" - BSP	34	22	413 021 034	47	20	

STRAIGHT PUSH FITTING

HBS





D mm	B mm	L mm	Part. no.	P g	n°	
14	20	48	413 014 048	62	20	

L PUSH FITTING

HBS

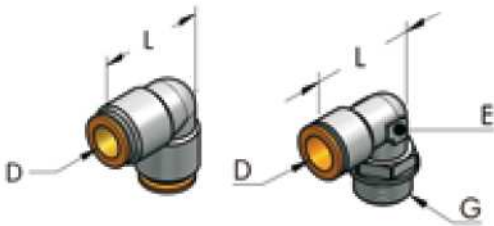
AP



D mm	G	L mm	E mm	Part. no.	P g	n°	
14	-	35	-	414 014 035	77	20	
14	1/2" - BSP	35	18	414 021 035	88	20	

T PUSH FITTING

HBS

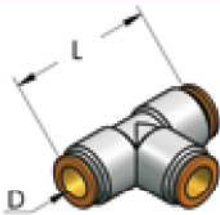



D mm	L mm	Part. no.	P g	n°	
14	70	414 014 070	110	20	

AIR REGULATION UNIT

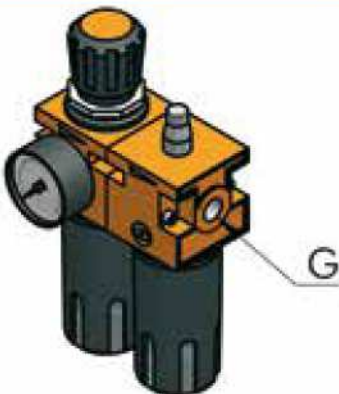
SYS



G	Configuration	Part. no.	P g	n°	
3/8" - BSP	Pressure regulator, filter, manometer	003 001 060	1200	10	
3/8" - BSP	Regulator, filter, lubricator, manometer	003 001 062	2000	10	

M/F NIPPLE WITH TAPERED THREAD

SYS

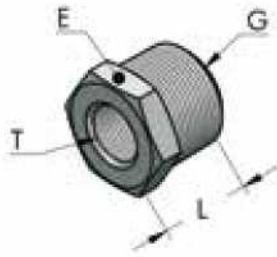

G	T	L mm	E mm	Part. no.	P g	n°	
1/2" - BSP	1/4" - BSP	16	24	417 021 016	31	20	

THREADED PLUG, WITH SEAL

SYS

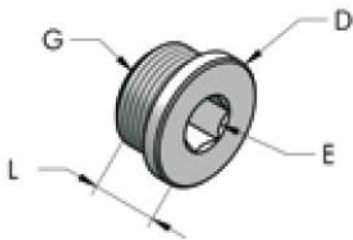

G	D mm	L mm	E mm	Part. no.	P g	n°	
1/4" - BSP	18	11	6	418 014 011	10	20	
3/8" - BSP	21	13	8	418 017 013	20	20	
1/2" - BSP	26	15	10	418 021 015	32	20	

FEMALE FLANGE EN 1092

HBS

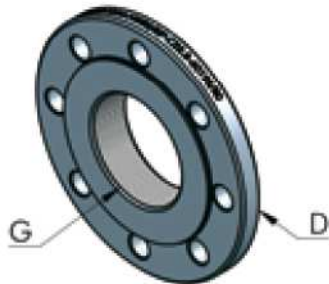

D mm	G	holes	Part. no.	P g	n°	
200	3" - BSP	8	436 085 035	3800	10	
220	4" - BSP	8	436 114 040	5000	10	

M/M THREADED NIPPLE

SYS

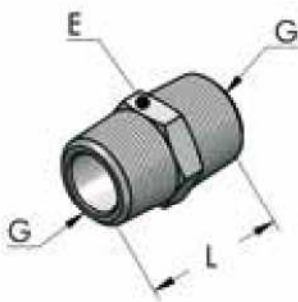

G	L mm	E mm	Part. no.	P g	n°	
3/8" - BSP	28	17	417 017 028	26	20	
1/2" - BSP	35	22	417 021 033	44	20	
3/4" - BSP	40	27	417 026 040	78	20	
1" - BSP	34	34	417 033 034	221	20	
1 1/2" - BSP	60	55	417 048 060	290	20	

CONDENSATE DRAIN

HBS

AP

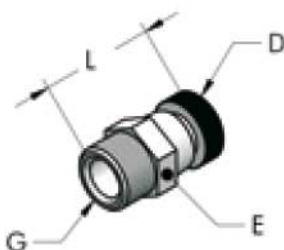

G	D mm	L mm	E mm	Part. no.	P g	n°	
1/4" - BSP	13	26	14	435 014 035	20	10	
3/8" - BSP	14	27	17	435 017 024	30	10	

HBS AP POW

F/F BALL VALVE



G	L mm	Part. no.	P g	n°	
1/2" - BSP	50	434 021 050	170	10	
3/4" - BSP	68	434 026 070	300	10	
1" - BSP	80	434 033 080	420	10	
1"1/4 - BSP	90	434 042 080	670	10	
1"1/2 - BSP	100	434 048 100	990	10	
2" - BSP	115	434 060 120	1600	10	
2"1/2 - BSP	150	434 075 150	3550	10	

HBS AP POW

M/F BALL VALVE

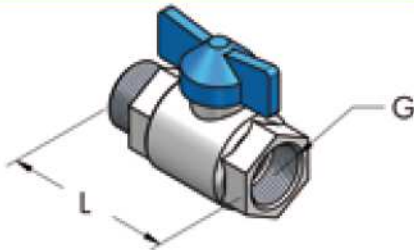

L mm	G	Part. no.	P g	n°	
55	3/8" - BSP	434 010 055	150	10	
67	1/2" - BSP	434 021 067	210	10	
82	3/4" - BSP	434 026 075	360	10	

ATS WBA SAB HBS

BALANCER FOR TOOL ATTACHMENT



F Kg	Part. no.	P g	n°	
0,4 ÷ 1	001 003 072	500	1	
1 ÷ 2	001 003 073	500	1	

SYS

DEBURRING TOOL

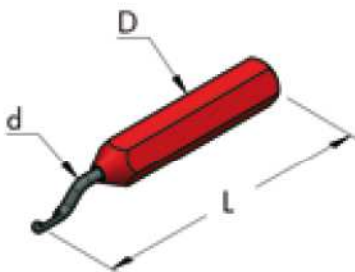

d mm	D mm	L mm	Part. no.	P g	n°	
3	14	150	909 012 130	55	10	
3	Spare blade		909 003 047	3	10	

SYS

ALLEN SPANNER

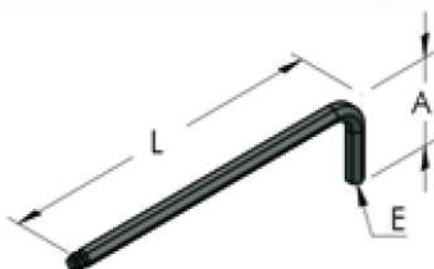

E mm	A mm	L mm	Part. no.	P g	n°	
5	34	140	901 130 005	30	10	

ALLEN SCREW DRIVER

AP POW

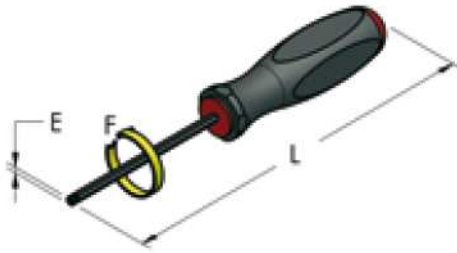

E mm	L mm	F	Part. no.	P g	n°	
4	200	6-10	901 170 004	40	1	
5	220	6-14	901 190 005	75	1	

DRILLING TOOL

SYS

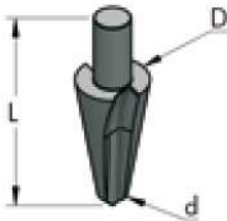

D mm	d mm	L mm	Part. no.	P g	n°	
20	8	62	922 020 062	46	1	

SMALL PLASTIC FOOT

HBS



d mm	A mm	Part. no.	P g	n°	
25	20	293 025 022	8	20	
32	25	293 032 025	10	20	

SMALL WHEEL

WBA



A mm	d mm	G	Part. no.	P g	n°	
110	80	M12	381 080 104	380	10	

HEXAGONAL NUT M6 FOR HILTI SYSTEM

SYS

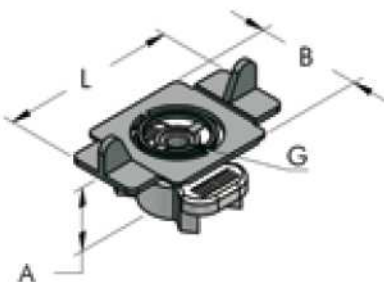

L mm	B mm	A mm	G	Part. no.	P g	n°	
50	30	15	M6	233 006 034	22	50	

HEXAGONAL NUT

SYS

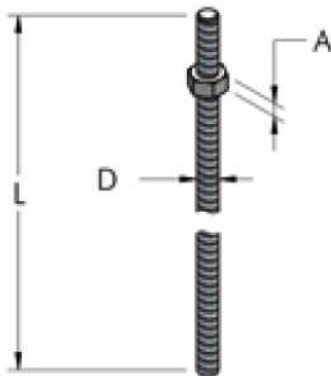

D mm	A mm	Part. no.	P g	n°	
M6	5	230 006 005	2,5	20	

HANGING TIE ROD

D mm	L m	Part. no.	P g	n°	
M6	1	226 006 100	200	10	

BUCKLE

SYS

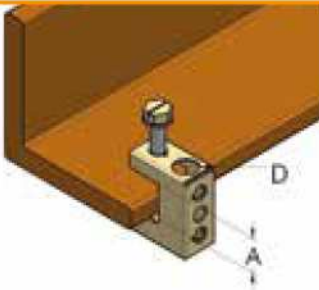

D mm	A mm	Part. N°	P g	n°	
10	18	294 010 018	25	20	

SNAP CLAMP FOR ELECTRIC BUSBAR (ZUCCHINI)

SYS

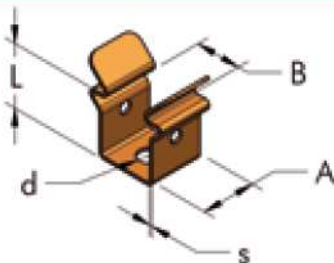

L mm	B mm	A mm	d mm	S mm	Part. N°	P g	n°	
20	22	18	7,5	1	292 022 020	20	10	

ALLEN SCREW 5X38

SYS

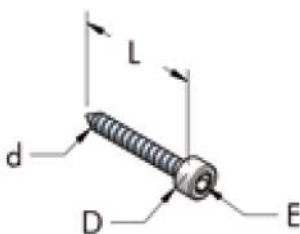

L mm	D mm	d mm	E mm	Part. N°	P g	n°	
38	10	5	5	206 005 038	5,7	100	

PLUG SX8

SYS

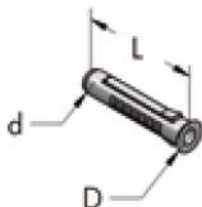

L mm	D mm	d mm	Part. N°	P g	n°	
40	10	7,6	208 008 040	1,5	100	